

## REDEVELOPMENT FOR LEASE

304 E Lake St  
Minneapolis, MN 55408



*Please contact for more information:*

**Mark Krogh**  
mark@javaprop.com

**Andy Urness**  
andy@javaprop.com

**952 403 9595**

## RESTAURANT / RETAIL

304 E Lake St  
Minneapolis, MN 55108

<b>BUILDING SIZE:</b>	4,000 sq ft Subdividable to 1,000 sq ft
<b>RENTAL RATES:</b>	\$17 Net
<b>OPERATING COSTS:</b>	~\$5.00 per sq ft
<b>PARKING:</b>	Abundant off-street parking

**ADDITIONAL COMMENTS:**

Redevelopment Opportunity on Lake Street  
Outstanding visibility on Lake St.  
Traffic Count: 18,400 plus cars a day  
Located next to McDonald's & Taco Bell  
Controlled intersection  
Owner would look at doing a land lease

*Please contact for more information:*

**Mark Krogh**  
mark@javaprop.com

**Andy Urness**  
andy@javaprop.com

**952 403 9595**

## GOOGLE MAP

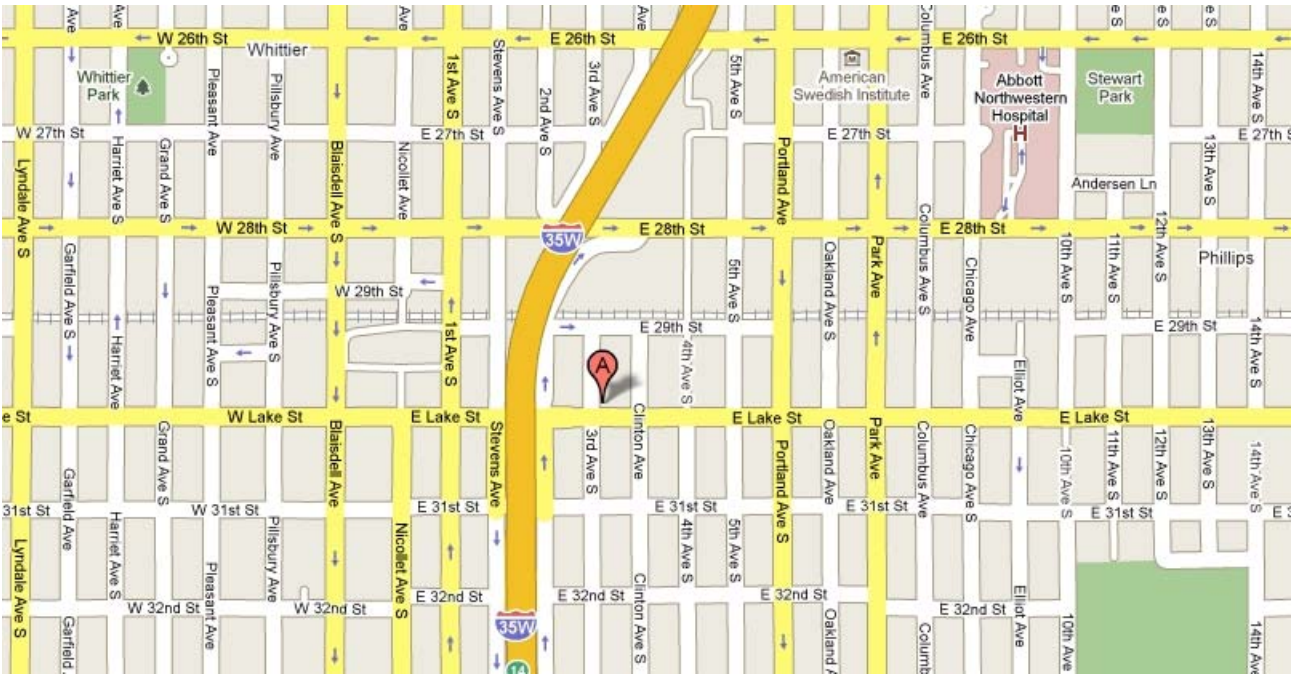

*Please contact for more information:*

**Mark Krogh**

[mark@javaprop.com](mailto:mark@javaprop.com)

**Andy Urness**

[andy@javaprop.com](mailto:andy@javaprop.com)

**952 403 9595**



## SATELLITE MAP



*Please contact for more information:*

**Mark Krogh**  
mark@javaprop.com

**Andy Urness**  
andy@javaprop.com

**952 403 9595**

## 18,400 VEHICLES PER DAY

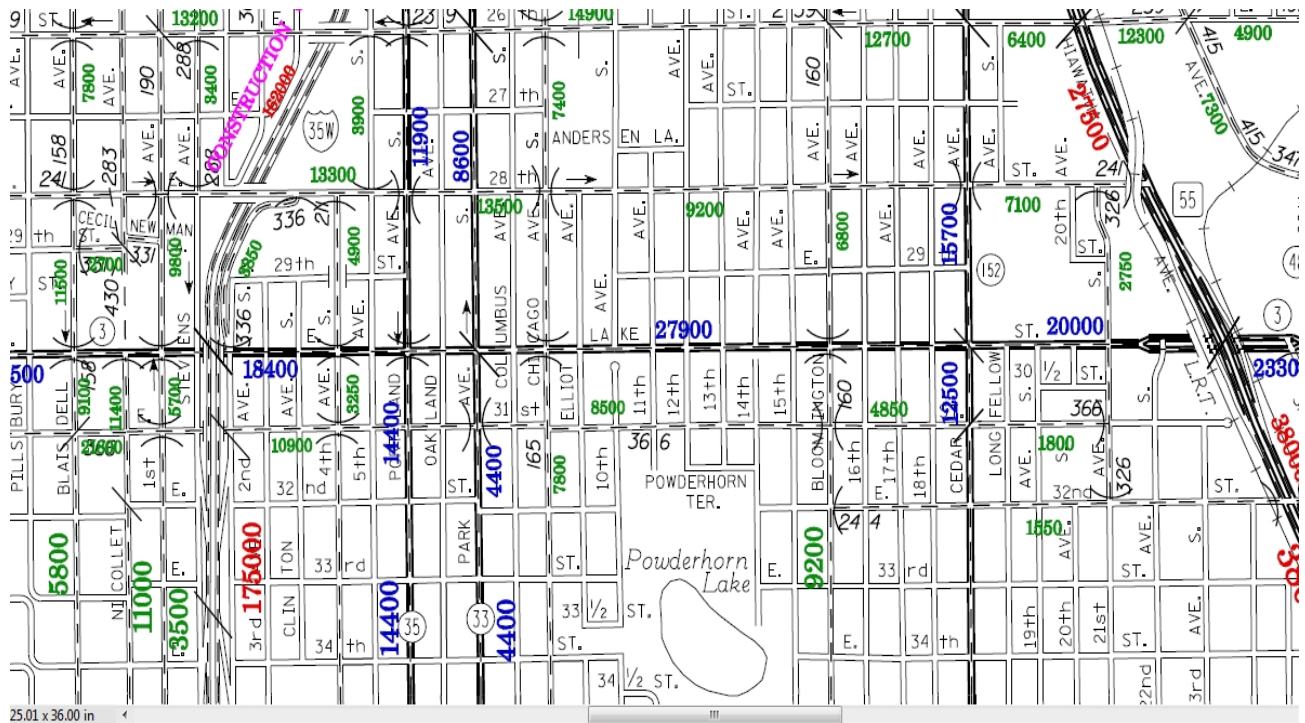

Please contact for more information:

**Mark Krogh**  
mark@javaprop.com

**Andy Urness**  
andy@javaprop.com

# 952 403 9595

# TAX PARCELS



Please contact for more information:

**Mark Krogh**  
mark@javaprop.com

**Andy Urness**  
andy@javaprop.com

## 952 403 9595